



## Product Catalogue

Hire Products & Design Ideas





# Contents

About Us	04
Exhibitions	06
Events	06
Design, Project Management & Production	08
Sustainable Practices	09
New Furniture Ideas	10
01. Furniture Packages	14
02. Chairs	18
03. Stools & High Bars	20
04. Coffee Tables & Tables	22
05. Lounges, Seats & Ottomans	24
06. Cupboards & Counters	26
07. Displays	28
08. Accessories & Plants	30
09. Audio Visual	32
10. Staging & Flooring	34
11. Lighting & Electrical	36
12. Graphics & Signage	38
13. Exhibition Systems	40
14. Stand Packages	44
15. Unique Conference Options	52
16. Feature Areas	54
17. Brand Activations	56
18. Custom Projects	58





# About Exponet

For more than 40 years, Exponet has delivered award-winning and world-class solutions across major events and exhibitions, government, trade and public shows, consumer and corporate activations, styling, fit outs and custom projects.

With international reach, and in-house design and production facilities in Sydney, Melbourne and Brisbane/ Gold Coast, Exponet has the backing of solid networks and infrastructure.

Our design and project management team combined with our experienced account managers will help you achieve the seemingly impossible and provide unmatched, seamless service.

We are passionate about offering custom solutions, with our extensive range of event equipment, detailed venue knowledge, proactive project management, innovative technology solutions and stylish furniture products.

As your partner we listen, create and deliver outstanding products and solutions, ensuring every event is a runaway success.



## Exhibition Management Specialists

Capturing the essence of your brand and transforming it into a three-dimensional, experiential marketing space is what our Account and Project Managers do best.

We pride ourselves on applying expert industry knowledge and the latest offering in infrastructure to create activations that uphold your brand's integrity and credibility as well as offer an outcome that enables maximum engagement on the show floor.

## Your Award Winning Partner

We have been consistently recognised for our outstanding innovation, design and delivery of exhibitions, custom projects and events, both locally and internationally.





# Exhibitions

## Your partner in exhibitions

Take advantage of Exponet's 40 years of outstanding design, project management, and delivery experience for conferences and exhibits around Australia. From exhibition stand design and construction to furniture, style, signs, graphics, audiovisual, staging, production equipment, flooring, electricity, lighting and much more, we offer comprehensive solutions for all your needs.

The Exponet team has created a handy exhibitor guide, drawing inspiration from our purpose to be your partner in event and exhibition success. The Exponet Exhibitor Guide is packed with advice and suggestions for anyone trying to get the most out of their exhibition booths or three-dimensional marketing displays, from novice exhibitors to seasoned merchants. Visit our website to download a copy.

# Events

## Events made easy

Organise an event without limits.

To put together the components of an outstanding event, choose from Exponet's seats, staging, theming, electricity, lighting, video equipment, signage, décor ideas, specially designed feature areas, and elegant furniture for your event.









## Designed for You

The sky's the limit when designing and building engaging environments. Our philosophy is simple, we work in partnership with you.

Add our creative, dynamic design, project management expertise and extensive production facilities when planning your high impact event, anywhere across the nation.



# Sustainable Practices

We are committed to a sustainable future

Our business was founded with the idea of reusable, environmentally-friendly hire items. We have kept this focus as we have expanded with projects, including smarter system construction materials, using eco-print solutions, recyclable signs, energy-efficient LED lighting and power alternatives, transportation and warehousing efficiencies, and involving employees and stakeholders in sustainable initiatives.



# Fresh Furniture Concepts



Marco Armchair (White | 1690) and Paris Coffee Table (Black | 2028)



Mono Coffee Table (Gold | 2075) and Mono Ottoman (White | 1684)

Mono Bar Table (Gold | 2065)



The Gold Collection



## European design and production

We have hand-picked a selection of brand-new furniture with the highest European quality standards for design and manufacture, bringing innovation and flair to enhance the visibility of your business.



Paris Vogue Chair (Velvet Pink/Gold | 2023)



Paris One Seater Lounge (White | 2015) and Monaco Coffee Table (Gold | 1793)



Paris One Seater Lounge (Black | 2016) and Paris Coffee Table (White | 2027)

Exclusive to Exponet



Marco Armchair (White | 1690) and Paris Coffee Table (Black | 2028)







Sleek Italian Styling

# 01. Furniture Packages







Walk-on Registration

○ 1940 ● 1941



Walk-on Table

○ 1965 ● 1966



Walk-on Bar

○ 1968 ● 1969



Studio Lounge

○ 1916 ● 1917



Siena Lounge

○ 1992 ● 1993 ● 1994



Metro Lounge

○ 1914 ● 1915

Icon Key



> outdoor



> powered



> add-on available

Rates exclude GST. Rates are for duration of the exhibition. Damage waiver, cartage & placement charges apply. Regional surcharges apply outside metropolitan areas in Sydney, Melbourne & Brisbane/Gold Coast. Please refer to ExpoNet.com.au for our Full Terms & Conditions of Hire for our Furniture, audio visual and signage ranges.



Nassau Table

○ 1910 ● 1911 ● 1912 ● 1913



Uni Table

○ 1920 ● 1921 ● 1922 ● 1923



Uni Mono Table

○ 1925 ● 1926 ● 1932 ● 1933



Fineline Table

○ 1945 ● 1946



Oasis Table

○ 1900 ● 1901 ● 1903 ● 1904 ● 1905



Ava Chair

○ 1952



Bentwood Chair

○ 1745 ● 1746







Nassau Bar Table

○ 1960 ● 1961 ● 1962 ● 1963



Uni Bar Table

○ 1970 ● 1971 ● 1972 ● 1973



Uni Mono Bar Table

○ 1934 ● 1935 ● 1936 ● 1937



Regent Bar

○ 1930 ● 1931



Fineline Bar

○ 1948 ● 1949



Oasis Bar

○ 1950 ● 1951 ● 1953 ● 1954 ● 1955



Ava Bar

○ 1967



Bentwood Bar

○ 1747 ● 1748



Icon Key



> outdoor



> powered



> add-on available

Rates exclude GST. Rates are for duration of the exhibition. Damage waiver, cartage & placement charges apply. Regional surcharges apply outside metropolitan areas in Sydney, Melbourne & Brisbane/Gold Coast. Please refer to ExpoNet.com.au for our Full Terms & Conditions of Hire for our furniture, audio visual and signage ranges.

# 02. Chairs



**Nassau**

L425 D420 H810 S480

○ 1005 ● 1006 ● 1009

● 1008



**Paris Burgundy**

L580 D580 H810 SH470

● 2019



**Claire**

L520 D550 H790 S450

● 1098



**Tolix Timber**

L400 D460 H830 S440

● 1024



**Finline**

L450 D530 H850 S470

○ 1050 ● 1051





**Uni**  
L420 D500 H790 S470  
○ 1015 ● 1016 ● 1017  
● 1018



**Uni Mono**  
W420, D500 H790 SH470  
○ 1750 ● 1751 ● 1752  
● 1753



**Skin**  
L515 D480 H780  
○ 1037 ● 1036 ● 1038  
● 1039



**Conference Linkable**  
L460 D460 H810 S460  
● 1052



**Agami Chair**  
L500 D510 H810 SH460  
○ 2035 ● 2036 ● 2037  
● 2038



**Paris Velvet**  
L580 D580 H810 SH470  
○ 2020



**Paris Vogue**  
L500 D530 H800 SH470  
● 2023



**Ice Acrylic**  
L440 D440 H800 S480  
● 1073 ● 1075 ● 1077  
● 1079



**Oasis**  
L450 D450 H770 S470  
○ 1000 ● 1001 ● 1003  
● 1004



**Bentwood**  
L400 D460 H830 S440  
○ 1072 ● 1089



**Ava**  
L400 D500 H810 S450  
○ 1035



**Boardroom**  
L650 D650 H1000 S440  
● 1087  
Adjustable



**Tolix**  
L400 D460 H830 S440  
○ 1025 ● 1026 ● 1027  
● 1028 ● 1029



**Uni-ka**  
L600 D500 H830 S470  
○ 1080 ● 1081



**Bora**  
L490 D540 H830  
○ 1033 ● 1034



**Typist**  
L500 D480 H840+ | S480+  
● 1096  
Adjustable



**Rocco Visitor**  
L600 D570 H950 S500  
○ 1085 ● 1095



**Rondo**  
L680 D500 H790+ S400+  
○ 1055 ● 1056  
Adjustable



**Rocco Executive**  
L650 D650 H950 | S520  
○ 1083 ● 1084  
Adjustable



**Novite Folding**  
L460 D525 H840 S450  
○ 1090



**Paris Luxe**  
L510 D590 H840 SH470  
○ 2025



**Echo**  
L550 D570 H840 S470  
○ 1060



Icon Key



> outdoor



> powered



> add-on available

Rates exclude GST. Rates are for duration of the exhibition. Damage waiver, cartage & placement charges apply. Regional surcharges apply outside metropolitan areas in Sydney, Melbourne & Brisbane/Gold Coast. Please refer to ExpoNet.com.au for our Full Terms & Conditions of Hire for our Furniture, audio visual and signage ranges.

# 03. Stools & High Bars



Stools



**Rondo**  
L530 D440 H700+ | S530+  
○ 1155 ● 1156  
Adjustable



**Regent**  
L400 D400 H630+ | S520+  
○ 1130 ● 1131  
Adjustable



**Echo**  
L500 D500 H1120 | S760  
○ 1160



**Paris Burgundy**  
L580 D550 H1040 SH760  
● 2021



**Tolix**  
L440 D440 H750 | S750  
○ 1125 ● 1126 ● 1127  
● 1128 ● 1129 ● 1198



**Tolix Timber**  
L440 D440 H750 | S750  
● 1124



**Paris Luxe**  
L510 D550 H990 SH760  
○ 2026



**Bora**  
L490 D510 H970 | S760  
○ 1133 ● 1134



**Diva**  
L450 D400 H670+ | S570+  
○ 1170 ● 1171  
\*Adjustable



**Skin**  
L520 D510 H1030 | S760  
○ 1137 ● 1136 ● 1138  
● 1139



**Uni Mono**  
L450 D500 H1120 SH750  
○ 1754 ● 1755 ● 1756  
● 1757



**Oasis**  
L480 D530 H1000 | S760  
○ 1100 ● 1101 ● 1103  
● 1104



High Bars



**Fineline**  
L400 D440 H970 | S750  
○ 1150 ● 1151



**Ava**  
L480 D520 H1090 | S800  
○ 1135



**Uni**  
L420 D500 H1100 SH770  
○ 1115 ● 1116 ● 1117



**Paris Vogue**  
L510 D540 H1100 SH800  
● 2024



**Paris Velvet**  
L580 D550 H1040 SH760  
○ 2022



**Bentwood**  
L420 D500 H1080 | S760  
○ 1172 ● 1189



**Drafting Stool**  
L530 D450 H1100+ | S730+  
● 1196 \*Adjustable



**Nassau**  
L425 D420 H930 S770  
○ 1105 ● 1106 ● 1107  
● 1108



**Aqami**  
L500 D510 H1010 SH780  
○ 2039 ● 2040 ● 2041  
● 2042



**Expo Square**  
L600 D600 H1120  
○ 1350 ● 1351 ● 1352  
● 1353 ● 1354



**Expo Hexagon**  
L700 D620 H1120  
○ 1355 ● 1356 ● 1357  
● 1358 ● 1359



**Timberland Round**  
Dia600 H1120  
● 1324



**Mono Bar Table**  
DIA 600 H 1120  
○ 2061 ● 2062 ● 2065



**Expo Round**  
Dia600 H1120  
○ 1320 ● 1321 ● 1322  
● 1323 ● 1314



**All Black**  
Dia600 H1120  
● 1319



**Bora**  
L700 D700  
○ 1228 ● 1229



**Provincial**  
Dia690 H1050  
○ 1315 ● 1316



**Tolix**  
L800 D800 H1060  
○ 1325 ● 1326



**Oasis**  
L750 D750 H1050  
○ 1300 ● 1301 ● 1303  
● 1304 ● 1305



**Nova**  
L1150 D500 H1050  
○ 1310 ● 1311 ● 1312



**Timberland**  
L1400 D600 H1050  
● 1389



**Avanti Shelf**  
L1400 D590 H1100  
○ 1578



**Avanti**  
L1400 D590 H1100  
○ 1599



**Avanti Square**  
L790 D590 H1100  
○ 1579



**Expo Bench**  
L1500 D600 H1000  
○ 1585 ● 1586 ● 1587  
● 1588



**Industrial**  
L1450 D600 H1075  
○ 1383

Icon Key



> outdoor



> powered



> add-on available

# 04. Coffee Tables & Tables



## Coffee Tables



**Expo Round**  
D600 H450  
○ 1370 ● 1371 ● 1372  
● 1373 ● 1374



**Timberland Round**  
D600 H440  
● 1388



**Expo Square**  
D600 H440  
○ 1360 ● 1361 ● 1362  
● 1363 ● 1364

## Tables



**Provincial**  
D690 H730  
○ 1215 ● 1216



**Expo Square**  
L750 D750 H740  
○ 1250 ● 1251 ● 1252  
● 1253 ● 1254



**Agami Table**  
L790 D790 H740  
○ 2045 ● 2046





**All Black**  
D600 H420  
● 1399



**Carlo Small**  
D400 H400  
○ 1333



**Carlo Large**  
D500 H400  
○ 1334



**Metro**  
D400 H550  
○ 1387



**Paris**  
L630 D630 H400  
○ 2027 ● 2028



**Monaco**  
D480 H480  
○ 1791 ● 1792 ● 1793



**Mono**  
D600 H 1120  
○ 2071 ● 2072 ● 2075



**Bora**  
L1000 D600 H400  
○ 1331 ● 1332



**Industrial**  
L1140 D590 H490  
● 1384



**Edge**  
L1000 D500 H400  
○ 1380 ● 1381



**Expo Hexagon**  
D600 H440  
○ 1365 ● 1366 ● 1367  
● 1368 ● 1369



**Nova**  
L1100 D505 H500  
○ 1390 ● 1391 ● 1392



**Oasis**  
D505 H475  
○ 1375 ● 1376 ● 1377  
● 1378 ● 1379



**Symbol Round**  
D400 H400  
○ 1386



**Oasis**  
L750 D750 H740  
○ 1200 ● 1201 ● 1203  
● 1204 ● 1205



**Timberland Round**  
D800 H780  
● 1224



**All Black**  
D800 H740  
● 1219



**Mono Table**  
D800 H 740  
○ 2051 ● 2052 ● 2055



**Expo Hexagon**  
L925 D810 H740  
○ 1255 ● 1256 ● 1257  
● 1258 ● 1259



**Expo Round**  
D800 H740  
○ 1210 ● 1211 ● 1212  
● 1213 ● 1214



**Bora**  
L800 D800 H720  
○ 1328 ● 1329



**Expo Meeting**  
L2000 D800 H740  
○ 1282 ● 1281



**Table Cloth**  
L3200 D1530  
○ 1887 ● 1888



**Plastic Trestle**  
L750 H730  
○ 1285 / 1.5m  
○ 1286 / 1.8m



**Nova Square**  
L750 D750 H770  
○ 1290 ● 1291 ● 1292



**Nova 1.8**  
L1800 D750 H750  
○ 1270 ● 1271 ● 1272



**Timberland Dining**  
L1800 D750 H750  
● 1289



**Nova 1.5**  
L1500 D750 H750  
○ 1267 ● 1268 ● 1269

Icon Key



> outdoor



> powered



> add-on available

Rates exclude GST. Rates are for duration of the exhibition. Damage waiver, cartage & placement charges apply. Regional surcharges apply outside metropolitan areas in Sydney, Melbourne & Brisbane/Gold Coast. Please refer to ExpoNet.com.au for our Full Terms & Conditions of Hire for our Furniture, audio visual and signage ranges.

# 05. Lounges, Seats & Ottomans



## Lounges



**Monaco Straight**  
L900 D980 H760 SH400  
○ 1693 ● 1695



**Monaco Corner**  
L1300 D980 H760 SH400  
○ 1694 ● 1696



**Jazz 2 Seater**  
L1360 D700 H850  
● 1632 ● 1633 ● 1634



**Agami 2 Seater**  
L145 D740 H810 SH415  
● 2043

## Seats



**Paris One seater**  
L700 D800 H790 SH450  
○ 2015 ● 2016



**Marco Armchair**  
L710 D900 H810 SH400  
○ 1690



**Miami Tub**  
L1000 D740 H760  
● 1637 ● 1638 ● 1639



**Studio 1 Seat**  
L600 D550 H800  
○ 1607 ● 1608

## Ottomans



**Long Ottoman**  
L1500 D400 H450  
○ 1685 ● 1686



**Monaco Ottoman**  
L1200 D 420 H400  
○ 1684



**Ottoman**  
L1500 D400 H450  
○ 1687 ● 1688



**Alusi Ottoman**  
L1000 D500 H400  
○ 1680 ● 1681





**Bora 2 Seater**  
L1160 D700 H860  
○ 1167 ● 1168



**Carlo 2 Seater**  
L1350 D670 H730  
● 1609



**Miami 2 Seater**  
L1730 D690 H750  
● 1652 ● 1653



**Studio 2 Seat**  
L1100 D600 H800  
○ 1615 ● 1619



**Oasis Double**  
L1340 D370 H830  
○ 1656



**Siena 2 Seat**  
L1380 D560 H770  
○ 1610 ● 1621



**Metro**  
L1460 D720 H690  
○ 1600 ● 1601



**Oasis Single**  
L600 D370 H830  
○ 1655



**Bora 1 Seater**  
L670 D710 H865  
○ 1067 ● 1068



**Carlo 1 Seater**  
L650 D650 H720  
● 1604



**Albury Tub**  
L580 D600 H810  
○ 1091 ● 1082



**Miami 1 Seater**  
L750 D690 H750  
○ 1650 ● 1651



**Siena 1 Seat**  
L890 D560 H770  
○ 1605 ● 1620



**Jazz Chair**  
L600 D540 H800  
● 1622 ● 1623 ● 1624



**Agami 1 Seater**  
L740 D740 H810 SH415  
● 2044



**Paris Ottoman Black**  
L1130 D430 H 430 SH430  
● 2018



**Paris Ottoman Gold**  
L1130 D430 H 430 SH430  
● 2017



**Euro Ottoman**  
L500 D500 H450  
○ 1660 ● 1661 ● 1662  
● 1663



**Round Single**  
L470 D470 H460  
○ 1665 ● 1666 ● 1667



**Round Double**  
L1080 D470 H460  
○ 1670 ● 1671 ● 1672



**Round Triple**  
L1650 D470 H460  
○ 1675 ● 1676 ● 1677



**Dado Straight**  
L600 D600 H790  
○ 1698



**Dado Corner**  
L600 D600 H790  
○ 1699



**Dado Ottoman**  
L600 D600 H450  
○ 1697



**Miami Ottoman**  
L1500 D600 H1000  
○ 1190 ● 1191 ● 1192  
● 1193 ● 1194

Icon Key



> outdoor



> powered



> add-on available

Rates exclude GST. Rates are for duration of the exhibition. Damage waiver, cartage & placement charges apply. Regional surcharges apply outside metropolitan areas in Sydney, Melbourne & Brisbane/Gold Coast. Please refer to ExpoNet.com.au for our Full Terms & Conditions of Hire For our Furniture, audio visual and signage ranges.

# 06. Cupboards & Counters



## Cupboards



**Lockable Square**  
L600 D600 H1200  
● 1761



**Computer Module**  
L600 D600 H900  
● 1591



**Euro Module**  
L600 D600 H900  
○ 1570 ● 1571 ● 1572

## Counters



**Octanorm Reception**  
L1180 D570 H1230  
○ 1516  
\*may include graphic



**Regent Desk**  
L1180 D680 H730  
○ 1475 ● 1476



**Octanorm Registration**  
L1030 D535 H985  
○ 1517  
\*may include graphic





**Regent Small**  
L1100 D450 H725  
○ 1430 ● 1431



**Euro Cupboard**  
L1100 D450 H840  
○ 1400 ● 1401 ● 1402



**Avanti Left**  
L975 D455 H925  
○ 1596



**Avanti Right**  
L975 D455 H925  
○ 1597



**Expo Cupboard**  
L1000 D600 H900  
○ 1410 ● 1411 ● 1412



**Regent Large**  
L1200 D550 H950  
○ 1435 ● 1436



**Trio Cupboard**  
L880 D500 H450  
○ 1739



**Expo Module**  
L480 D500 H900  
○ 1580 ● 1581



**Show Counter**  
L1500 D600 H900  
○ 1550 ● 1551 ● 1552  
● 1553



**Z-Registration**  
L950 D800 H1250  
○ 1594



**Regent Reception**  
L1000 D520 H1250  
○ 1535 ● 1536



**Regent Registration**  
L1000 D520 H1030  
○ 1530 ● 1531



**Euro Counter**  
L1100 D450 H1100  
○ 1500 ● 1501 ● 1502



**Milan Counter**  
L750 D750 H1100  
○ 1526



**Milan Straight**  
L1600 D700 H1100  
○ 1525



**Information Booth**  
L1400 D500 H2500  
○ 1565 ● 1566



**Curved Reception**  
L1400 D500 H1218  
○ 1560 ● 1561



**Curved Registration**  
L1400 D500 H1030  
○ 1520 ● 1521



1516

\* You can put your branding on most of our counters. See Graphics and Signage for more.

Icon Key



> outdoor



> powered



> add-on available

Rates exclude GST. Rates are for duration of the exhibition. Damage waiver, cartage & placement charges apply. Regional surcharges apply outside metropolitan areas in Sydney, Melbourne & Brisbane/Gold Coast. Please refer to ExpoNet.com.au for our Full Terms & Conditions of Hire for our Furniture, audio visual and signage ranges.

# 07. Displays



**Executive Tower**  
L600 D600 H2000  
○ 1843



**Literature**  
L265 D280 H1200  
● 1798



**Cube 2**  
L400 D400 H510  
○ 1702



**Spiral Rail**  
Dia600 H1670  
● 1878



**Top Display**  
L1470 D450 H950  
○ 1840



**Straight Rail**  
On wheels | L1500 H1700  
● 1879



**Entry Box**  
L380 D380 H900  
○ 1884 ● 1881



**Literature Shelf**  
L700 D500 H1600  
● 1799



**Trio Shelf**  
L900 D500 H1700  
○ 1730 ● 1731 ● 1732



**Icon**  
L275 D275 H1200  
● 1776 ● 1779



**ZigZag**  
L325 D325 H1550  
○ 1780 ● 1781 ● 1784



**Trio Package**  
L900 D500 H1700  
○ 1735 ● 1736 ● 1737



**Cube Single**  
L400 D400 | H370 shelf gap  
○ 1720



**Cube Double**  
L1500 D470 H890  
○ 1725



**Rectangle 2**  
L600 D300 H510  
○ 1712



**Rectangle 3**  
L600 D300 H890  
○ 1713



**Rectangle 4**  
L600 D300 H1270  
○ 1714



**Cube 3**  
L400 D400 H890  
○ 1703



**Cube 4**  
L400 D400 H1270  
○ 1704



**Rectangle 5**  
L600 D300 H1650  
○ 1715



**Cube Step**  
2, 3, 4, 5 shelf combination  
○ 1709



**Rectangle Step**  
L600 D300 H1650  
○ 1719



**4-way Adjustable**  
L900 D900 H1200-1800  
● 1877



**Horizontal Panels**  
L1800 H1200  
● 1811



**Vertical Panels**  
L1200 H1800  
● 1821



**Slatwall Octanorm**  
L950 H2340  
○ 7050



**Slatwall Corinthian**  
L980 H2400  
○ 7055



**Executive Counter**  
L1200 D500 H900  
○ 1841



**Premier Mushroom**  
L900 D900 H900  
○ 1842



**ZigZag Triple**  
L727 D300 H1550  
● 1786 ● 1789



**Milan Display**  
L800 D500 H1500  
○ 1527





# 08. Accessories & Plants



Accessories



Oasis Cushion  
Cushion upgrade L340 D340  
○ 000 ● 001 ● 003  
● 004 ● 005



Entry Barrell  
L680 D465 H1100  
○ 1894



Tensa Barrier 2m  
L2000  
○ 1891

Plants



**Miami Cushions**  
W400 H400  
● 010 ● 011 ● 012  
● 013 ○ 014 ● 015  
● 016



**Oasis Lounge Cushion**  
L640 D530 H130  
● 656 ● 658 ● 659



**Bora 2 Seat Cushion**  
L1050 D535 H70  
○ 076 ● 079 ● 077  
● 078



**Bora 1 Seat Cushion**  
L570 D525 H80  
○ 066 ● 067 ● 068  
● 069



**Waste Bins**  
L1000 D200 H1000  
● 1898 | Dia500 H650  
● 1899 | Dia200 H300



**Three-Door Fridge**  
L1350 D520 H890  
○ 1873



**Fridge Bar**  
L500 D500 H850  
○ 1871  
Not for public display



**Fridge Tall**  
L540 D580 H1470  
○ 1870  
Not for public display



**Picket Fence**  
L1000 D200 H1000  
○ 1868 1m  
○ 1867 2m



**Floor Plan Box**  
L2000 D920 H1200  
Graphic size L1965 H966  
Includes 1x basic floorplan print  
○ 4116



**Cheval Mirror**  
L420 D400 H1555  
○ 1896



**Fashion Mirror**  
L600 D400 H1040  
○ 1892

## Plant types (may vary based on availability)

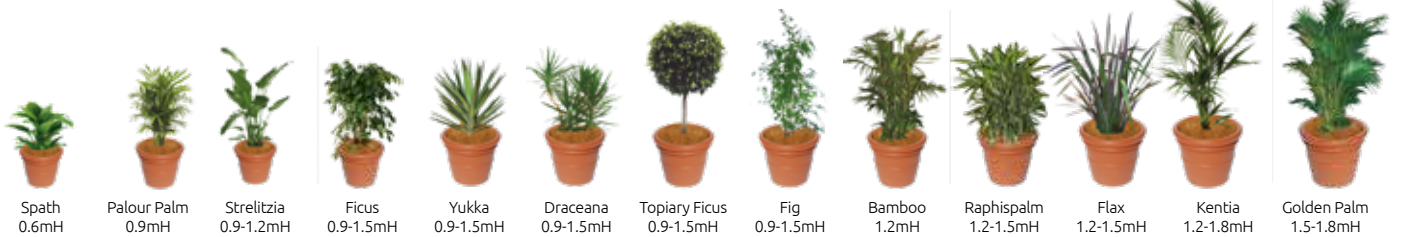

**Planter Box**  
8007 1m  
8008 1.2m  
Plants included



**Wedge Pot**  
○ 8010 ● 8011  
Plants not included  
Available in Syd and Melb only

## Sizing Chart

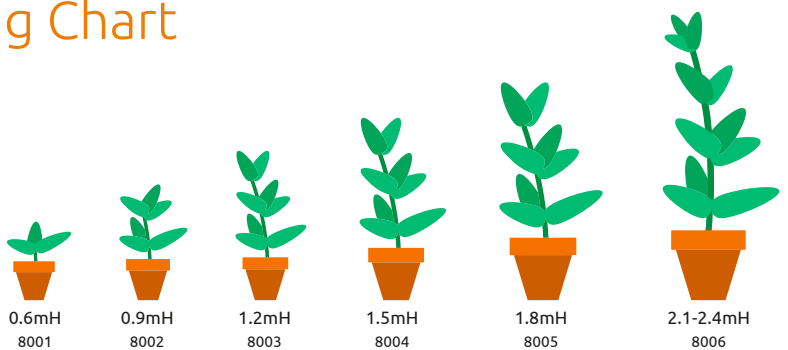

Illustrative purposes only, heights, pots and plant types vary across states/seasons and are subject to availability.

# 09. Audio Visual



Digital Display Kiosk 55"  
L800 D450 H1950  
1920x1080p  
Touch Screen & Standard Display



Icon Package (42")  
Screen and player  
included





**LCD Walls**  
Various sizes available



**LED Walls**  
Various sizes available



**Flat Screens**  
Various sizes available



**Touch Screens**  
Various sizes available



**Laptop**  
Standard & Professional available



**Laptop**  
Standard & Professional available



**Media Player**  
.mp4 .avi .mov .wmv files



**Projector Screens**



**Digital Projectors**



**Lectern**



**Easel, Flipchart, Board**



**Conference Sound Packs**



**Speakers Sound Packs**

**Code      Product Description**

- 3022 - 22" LED Monitor  
(data only /no sound)
- 3032 - 32" LED Screen
- 3042 - 43" LED Screenr
- 3055 - 55" LED Screen
- 3065 - 65" LED Screen
- 3075 - 75" LED Screen
- 3090 - 86" LED Screen
- 3121 - 22" LED Touch screen
- 3132 - 32" LED Touch Screen  
Android Based
- 3146 - 46" LED Touch Screen  
(includes Laptop)
- 3155 - 55" LED Touch Screen  
(includes Laptop)
- 3095 - 42" Icon Package  
(shelf not included)
- 3095 - 55" Icon Package  
(shelf not included)
- 3456 - Digital Signage Kiosk
- 3455 - Digital Signage Kiosk w/ Touchscreen  
(will not play Power point or PDF Files)
- 3105 - Media Player  
(best with mp4 no Power point)
- 3101 - Flat Screen Wall Mount Kit  
Octanorm for use with Exponet screens only
- 3102 - Flat Screen Hooks  
for use with Exponet screens only
- 3103 - Flat Screen Wall Mount Kit  
(custom stands only)
- 3801 - Octanorm Wall Mount kit  
through Fabric Banner for use with Exponet screens only
- 3802 - Infinity Wall Mount kit  
through Fabric Banner for use with Exponet screens only
- 3803 - Corinthian Wall Mount kit  
through Fabric Banner for use with Exponet screens only
- 3804 - Alivision Wall Mount kit  
through Fabric Banner for use with Exponet screens only
- 3113 - Icon Flat Screen Stand  
Only for use with Exponet screens only (shelf not included)
- 3112 - Truss Flat Screen Stand  
Only for use with Exponet screens only (shelf not included)
- 3203 - Laptop Computer Highend
- 3350 - Sound Pack (up to 100 people indoors)
- 3352 - Conference Amp Pack  
(200 People indoors)
- 3353 - Conference Amp Pack  
(400 People indoors)
- 3360 - Radio Mic UHF Lapel
- 3361 - Radio Mic UHF Hand Held
- 3362 - Radio Mic UHF Head Set
- 3510 - Lectern

**Conference Equipment**  
(Switchers, stage and control equipemnt)

**Projector Equipment (3000-20000 Lumen)**

**Projector Screens (Fast Fold , Tripod)**

\*Screen stands can only be hired with Exponet supplied screens.



**Head Set Mic**



**Head Set Mic**



**Hand Held Mic**

# 10. Staging & Flooring





Carpet Tiles (1x1m)

- 5000 Charcoal
- 5010 Blueberry
- 5025 Black
- 5045 Red
- 5050 Green



Needlepunch Carpet

- 5082 Black
- 5079 Light Blue
- 5084 Red
- 5085 Royal Blue
- 5085 Dark Green
- 5088 Dark Purple
- 5081 Grey
- 5087 Hot Pink
- 5086 White
- 5080 Other



32mm Raised Flooring with Needlepunch

- 5082 Black
- 5079 Light Blue
- 5084 Red
- 5085 Royal Blue
- 5085 Dark Green
- 5088 Dark Purple
- 5081 Grey
- 5087 Hot Pink
- 5086 White
- 5080 Other



32mm Raised Tile

- White
- Beech
- Oak



Astro Turf

- 5092 Green



Graphic Floor Tile

- 4065

# Staging



QAS Staging

L1220 D2440

Available in 150mm, 300mm, 600mm, or 900mm H



Available Stage Heights

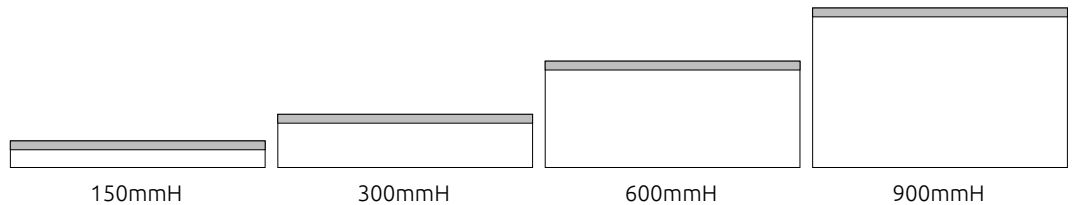



# 11. Lighting & Electrical





## Feature lighting elements and electrical components provide brands with the ability to propel their activations forward, ahead of competitors.

Exponet's specialists in electrical and lighting work alongside our design team to ensure that all platforms have the power to provide an electric outcome.

From colour washes, spot lighting, RGB programmable dream bars and more, Exponet have a comprehensive offering.

### Stand Lighting

Our latest LED products offer strong, heat-free, white light in an eco-friendly way for your stand.



### Custom Product

Be creative! We can deliver ideas from downlights to uplights, LED strips to specialised globes.

### Colour Washes

Be bold and use coloured specialty lighting to work with your corporate brand or event theme.



### Stand Power

From phone charging to industrial machinery, we have the equipment to deliver your power needs.

### Truss Lighting

For broader area lighting, we offer a range of truss mounted light products with strong, wide and bright light.



### External Power

Our weather-proof switchboards and cabling supply power to outdoor events in all conditions.

# 12. Graphics & Signage







Our team of creative designers and signage specialists can create any outcome, showcasing innovation and forward thinking.

We can assist to create a sense of arrival, a sense of environment or a sense of direction.

Additionally, we can work with you to create a more sustainable outcome, looking to alternate print methods and applications.



## Signage Items

Ready-made freestanding signage for all your show needs.



**Blackboard A-frame**  
1890 L700 D500 H1200



**A-frame**  
4100 L900 D710 H1260  
*Includes 1x print  
Graphic size L900 H1200*



**Portrait**  
4102 L540 H1470  
*Includes 1x print  
Graphic size L510 H780*



**Straight**  
4104 L1100 D540 H2500  
*Includes 1x print  
Graphic size L970 H2360  
Double-sided cost \$816*



**Curved**  
4105 L1100 D540 H2500  
*Includes 1x print  
Graphic size L1077 H2360*



**Gatorboard**  
4107 L890 D200 H2100  
*Includes 1x print  
Graphic size L890 H1960*

## Fabric

Fabric is a sustainable, recyclable and affordable option with a seamless wall finish.



## Custom signage

We have everything you need for a custom solution! Reach out to find out more.



## Sustainable printing solutions

We have a large range of printing substrates, including recyclable material printed with eco-inks.

# 13. Exhibition Systems



## Stand Build Options



### Octanorm

Octanorm Shell Scheme stands are the perfect platform for exhibitors to connect and engage with their target markets. With options to upgrade and/or apply additional signage solutions, shell scheme stands offer outcomes for all organiser and exhibitor requirements.

The Octanorm system is designed with a unique eight-sided post, which enables the use of 45 degree angles to create new and interesting stand designs. Octanorm is completely sustainable and returned for continual reuse.

#### Octanorm

2.5mH Octanorm structure with White Melamine panels or Silver Grey Fabric panels

### Corinthian

Corinthian Shell Scheme stands are a hallmark of the exhibition industry. Made of fabric-covered panels, corinthian is solid, streamlined and has the potential for signage opportunities such as fabric walling and seamless artwork.

Corinthian is completely sustainable and returned for continual reuse. It is also velcro-compatible, allowing for a range of custom opportunities for clients.

#### Corinthian

2.4mH Corinthian fabric covered walls available in Monarch Blue or Black



### Infinity

Infinity Shell Scheme offers clients the ability to upgrade from standard solutions, delivering impactful brand presentation and heightened customer experience. Infinity integrates and enhances existing industry expectation, transforming brands on a premium platform with seamless opportunities and considered display/ merchandising.

Infinity is completely sustainable and returned for continual reuse. Furthermore, clients can select from sustainable signage outcomes (such as fabric or DISPA) adding to the environmental integrity.

#### Infinity

2.5mH flush walling system inclusive of white seamless panels

### Grande

Create dynamic brand experiences that deliver on a high-end scale, reaching new heights with the Grande display solution.

Boasting three metre high black powder-coated framework, the Grande is designed to be a feature in and of itself, enhancing the overall display and customer experience. Grande creates elevated hotel pop-ups, pavilions and feature areas.

#### Grande

3mH frame with 2.5mH flush walling system inclusive of white seamless panels







## Lighting



### LED Track Spot

Bright white light. Low-power. Track mounted behind fascia. Directional. Colour globes avail.  
4116



### LED Vario

Bright white light. Low-power. Small flood light. Ideal for lighting product or a picture on a wall.  
2753

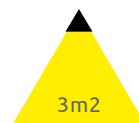

### 50W LED Floodlight

Bright White light. Wall-mounted. Ideal for lighting a 3m wall, signage or general stand floor area.

## Walling Bracket Types

### Octanorm Flat

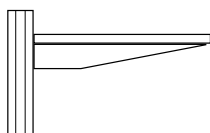

### Sloping

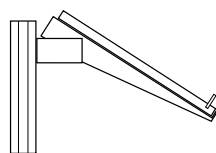

### Corinthian/Infinity Flat

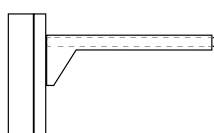

### Sloping

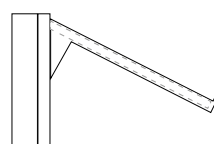

## Walling Shelving Options



black  
Flat, Sloping

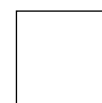

white  
Flat, Sloping



glass  
Flat

## Build your Stand

### 1. Carpeting

Select from Exponet's carpet offering, inclusive of Needle-punch and carpet tiles - available in varying colours.

### 2. Raised Flooring

Exponet offer raised flooring in 32mm and 45mm heights with a select finish to choose from.

### 3. Digital Print Infills

Achieve strong branding and take advantage of digital print infills.

### 4. Audio Visual

Select from a variety of digital display options.

### 5. Storeroom

Needing storage for your booth, talk to Exponet about adding in a lockable storage section.

### 6. Wall Shelving

Available in flat (in black, white or glass) or sloping (in black or white) and can apply to straight or corner configurations.

### 7. Rails

Displaying clothing or wanting to hang merchandise? Rails allow exhibitors to hang items, installed at various heights.

### 8. Slatwall

Slatwalling allows exhibitors to showcase merchandise (such as foot wear) via a series of horizontal slats installed into the framework.

### 9. Digital Print Fascia

Upgrade options are available for stand fascias, with extended height, alternate graphics or custom additions.



# 14. Stand Packages





## Custom Stand Packages deliver an immersive environment that is budget conscious, brand forward and sustainably aligned.

We know that each stand has its own unique requirements, marketing objectives, messaging and size, so we have designed our suite of packages with this in mind.

Whether your event presence is to promote services, launch a product, conduct meetings, host small workshops and presentations, or create a buzz, we have designs perfect for you.

Our packages offer a variety of inclusions such as signage, furniture packages, merchandising and display, audio visual and flooring.

You can achieve standout results with us, regardless of your space allocation.





Rome

9x6m configurations

9120

6x6m configurations

9121

6x3m configurations

9122



Milan

9x6m configurations

9125

6x6m configurations

9126



Venice

9x6m configurations

9127

6x6m configurations

9128



Verona

9x6m configurations

9130

6x6m configurations

9131

6x3m configurations

9132

9x3m configurations

9133



Modena

6x6m configurations

9135

6x3m configurations

9136



Florence

6x6m configurations

9140

6x3m configurations

9141



Pisa A

6x6m configurations

9160

6x3m configurations

9161



Pisa B

6x6m configurations

9162

6x3m configurations

9163



Pisa C

6x6m configurations

9164

6x3m configurations

9165



Pisa D

6x6m configurations

9166



Pisa E

6x6m configurations

9167

6x3m configurations

9168



Pisa F

6x6m configurations

9169





**Siena**

9x6m configurations

9170

6x6m configurations

9171



**Brighton**

6x3m configurations

9461



**Boston**

3x3m stand package

8805



**Presenter**

6x3m configurations

9720



**Sorrento**

6x3m stand package

9661



**Dynamic**

6x3m configurations

9721    9722



**Collaborator**

Hanging signage and rigging at additional cost  
6x3m configurations

- 9726
- 9725



**Insight**

6x3m configurations

- 9719
- 9718



**Trinity**

6x6m stand package available in configurations

- 9873



**Centraliser**

Stand Package in varying Formats

- 9500
- 9501
- 9510
- 9511
- 9512



**Brussels**

6x3m stand package

- 8815



**Amsterdam**

6x3m stand package

- 8820



**Illuminator**

3x3m configurations

9400  9401

6x3m configurations

9412  9411  9410



**Strand**

6x6m stand package

9573



**Styler**

3x3m configurations

9200  9201

6x3m configurations

9212  9210  9211



**Marketer**

3x3m configurations

9700  9701

6x3m configurations

9712  9710  9711



**Gibson**

6x3m configurations

9361



**Hamilton**

6x6m configurations

9772





**Burleigh**

6x3m configurations

9762



**Bondi**

6x3m configurations

9462



**Portsea**

3x3m stand package

9151



**Initiator**

3x3m configurations    6x3m configurations

9100    9101     9112    9111    9110



**Developer**

6x3m configurations

9724    9723



**Synergy**

3x3m configurations

9713



**Insight**

3x3m configurations

9717    9716



**Atlanta**

3x3m stand package

8800

# 15. Unique Conference Options





## Pods

Exponet's custom display pod is a great alternative to the basic exhibition modular stand – they occupy less space on your floor plan so are perfect for boutique venues.

They can be used strategically around your exhibition to inform visitors or to showcase various vendor products.

Pods can be designed to suit individual events or for use across multiple shows and years. Use graphic elements to brand your pods for maximum visual effect.

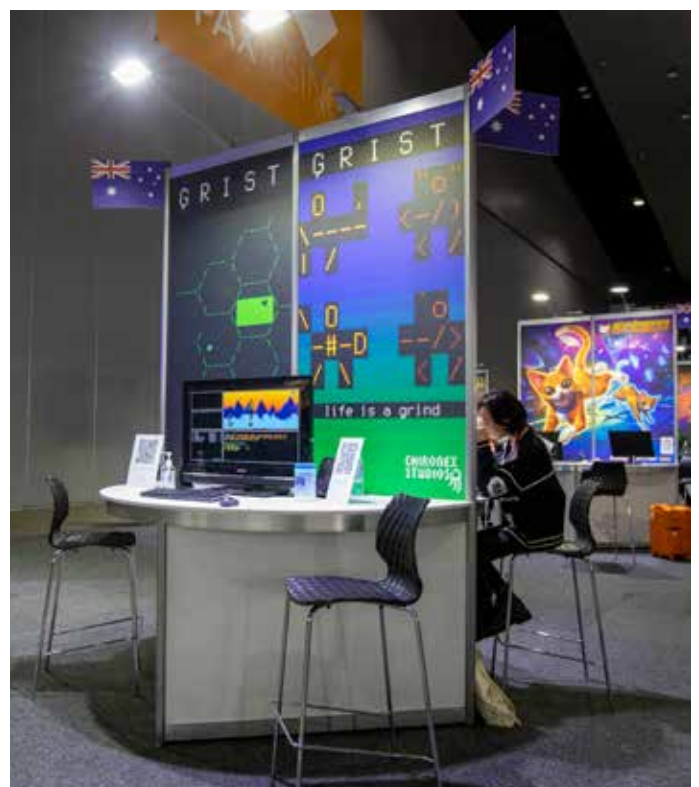



# 16. Feature Areas



## Eating, meeting, reception, staging and lounge areas

Create the areas where your attendees can register, network, recharge or relax.

From lounges to media centres and much more, let the Exponet team design and build your feature area.





# 17. Brand Activations







## Building Connections

Building connections between brands and customers is an essential part of your marketing mix. Activate your brand and provide your customers with the best opportunity to engage with your products, your people and brand.



# 18. Custom Projects





## Options are limitless when building engaging custom projects

No brief is too complex. We can create custom exhibition stands, 3D features, retail fit-outs and pop-up displays. Capturing the essence of your brand and transforming that into a three-dimensional, experiential marketing space is what our Custom Stand team do best.

Our team of designers and custom project managers have been consistently recognised for their high quality and innovative results.





# People, Product, Service.

## Sydney

45 Princes Road West  
Auburn NSW 2144  
Australia  
P 02 9645 7000  
F 02 9645 5300

## Melbourne

44 White Street  
South Melbourne VIC 3205  
Australia  
P 03 9676 7777  
F 03 9676 7788

## Brisbane/Gold Coast

25 Eurora Street  
Kingston QLD 4114  
Australia  
P 07 3442 4100  
F 07 3382 6066

[info@exponet.com.au](mailto:info@exponet.com.au)  
[exponet.com.au](http://exponet.com.au)

